



Hollywood 5400

Technical specifications

- › **Structure**
 - Made of tube and steel plate arc welding with continuous wire.
- › **Polyurethane foam**
 - Seat density: 60-65Kg/m³.
 - Backrest density: 50-55Kg/m³.
- › **Paint**
 - Electrostatic powder polyester paint.
 - Paint Thickness: 70-80 microns.
 - Grid adhesion according to UNE-EN ISO 2409 : 100%.
- › **Upholstery**
 - Reaction to fire standards:
 - Spain: UNE-EN 1021 Parts 1 and 2.
 - France: NF D 60-013.
 - Italy: UNI 9175 Class 1.IM.
 - Germany: DIN 66084.
 - USA: CAL TB117.
- › **Leather**
 - Adhesion to finish according UNE-EN ISO 11644: >2.5 N/cm².
 - Resistance to rubbing according UNE-EN ISO 11640: (Dry, 1.000 Cycles) >4.
- › **Polypropylene**
 - Material: Copolymer Polypropylene IF-727.
 - Tensile stress at yield according ISO 527-2: 26 Mpa.
 - Tensile Modulus according ISO 527-2: 1250 Mpa.
- › **Fire resistance**
 - BS 5852. Clause12. Ignition sources 0,1 and 5. (with approved fabric).
 - USA:CAL T.B. 133 (with approved fabric).
- › **Resistance and durability classification**
 - UNE-EN 12727 Level 4 (Severe use).
- › **Electric components**
 - Power supply: 110-230VAC 50-60Hz.
- › **CE Marking**
 - Compliance of the following European regulations:
 - 2006/42/EC Machinery Directive
 - 2014/35/EU Low Voltage Directive
 - 2014/30/EU Electromagnetic Compatibility Directive
- › **LIFE Cycle Service**
 - Figueras' reclining seats feature built-in technology. Due to its regular use, we recommend periodic check-ups to ensure a proper performance through time of use.
 - Figueras has developed its official in-house maintenance service product, Life Cycle Service, to extend product life and assure a safe environment. For more information, please see also product datasheet.

General dimensions

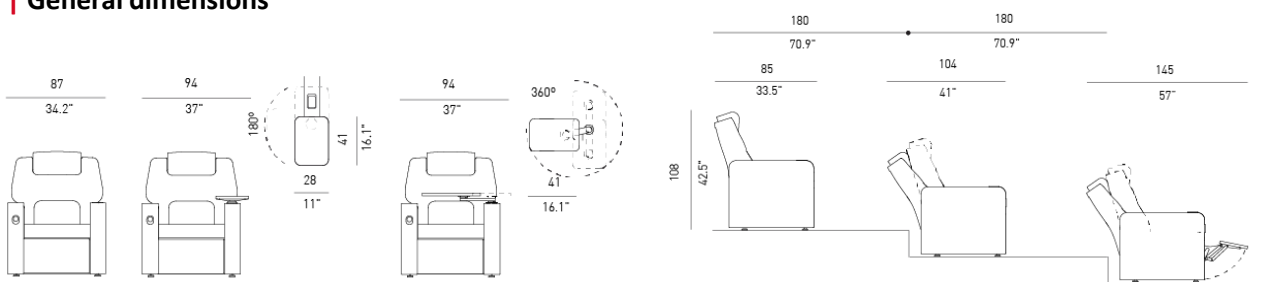

Hollywood 5400

Hollywood 5400 + TBL - Large

Hollywood 5400 + Double Hinge TBL

Hollywood 5400 on riser

However, for the purpose of facilitating to the customer the latest novelties, FIGUERAS reserves the right to introduce the modifications and variations that it considers most appropriate and suitable for marketing its products.

General description

› This is the new individual seat with high comfort and large dimensions that has been designed by Figueras to use in VIP lounges, cinemas and Home Cinema rooms.



· It is characterised by a modern design with elegant lines and its functionality and versatility. It is equipped with an automatic mechanism that allows the user to regulate the backrest and footrest depending on the user's preferences. Both movements are controlled by means of a touch screen located on the side of the seat, with extremely simple use instructions and easy access.

· Both the seat and the backrest consist of a main piece of cold moulded polyurethane foam that completely covers the metal structure, made up of a curved tube frame and a weft of flat springs, providing extraordinary comfort even during long stays. The block is upholstered with an easily interchangeable cover, thanks to a zipper system.

· The seat has an automatic return system, so that when the user stands up from the seat, the backrest and footrest automatically return to their original position. In this way, a neat appearance is always kept in the room and, in the case of row arrangement, the accesses are always free for movement between them.



· At the user's will, the backrest is tilted from its original position, by means of an electrical mechanism that is very smooth to use and free of noise, always achieving optimum visibility. The same mechanism is used in a front skirt that acts as a footrest and is lifted at the user's will.

· Optionally, different accessories may be incorporated to respond to the different uses of the same room: a generously sized lectern that is totally integrated into the seat when folded, cupholders attached to one of the arms with the possibility of attaching a tray, an individual rotating table or an intermediate table between two seats. The versatility of this seat makes it possible to hold a film session or a conference in the same room.



· The feet of the seat incorporate regulators to compensate for possible irregularities in the floor and always keep the seat in a perfectly stable position without the need for a fixation to the floor.

· The standard finishing is made of natural leather with microperforated areas that improve transpiration. The upholstery is entirely handmade. A 220V-230V power supply is required.

· Optionally, the headrest may also be motorized to adapt it depending on the user's preferences.

However, for the purpose of facilitating to the customer the latest novelties, FIGUERAS reserves the right to introduce the modifications and variations that it considers most appropriate and suitable for marketing its products.

However, for the purpose of facilitating to the customer the latest novelties, FIGUERAS reserves the right to introduce the modifications and variations that it considers most appropriate and suitable for marketing its products.

Materials and finishes

› Metal Parts Features

- The steel complies with the following European standards:
 - Tube up to 2mm thick: Alloy designation according to UNE-EN 10305 part 3: E-220.
 - Tube more than 2 mm thick: Alloy designation S275JR.
 - Plate: alloy designation according to EN 10111: DD12.

› Protection and Paint of Metal Parts

- Prior to powder coating, metal parts are treated with a three stage, non-acidic cleaning process to achieve superior finish adhesion. The finishing of the thermosetting polyester powder coating must be applied by electrostatic means with a minimum thickness of 70-80microns.

• After coating, the parts must be oven cured to create a durable finishing that meets the following requirements:

- Composition: Polyester powder suitable for outdoor use.
- Cross Cut Test Adhesion according to UNE-EN ISO 2409 classification GT 0-1.
- Scratch resistance according to ISO 15184:98 Level HB-H.
- Total thickness: 70-80Microns.
- Rust resistance (NSS), according to ISO 9220: 200 h.
- Resistance to MEK 50 double rubs without paint stripping.

- Blow-moulded polypropylene side selvages.

› Upholstery

• Integral Form / Traditional

• Group A:

Figueras Fabrics ®



• Group B:



• Group V:



• Only Traditional

• Group A:

Figueras Fabrics ®



• Group B:

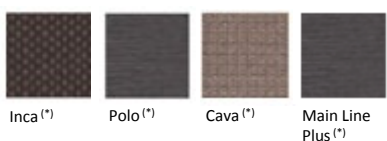

• Group L:

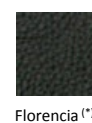

• Group L MTM:

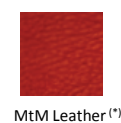

(*) Fabric sample / printed by collection. Check colours available.

(*) Quotation for traditional upholstery upon request.

› Pigments for metal parts

